

FRONT

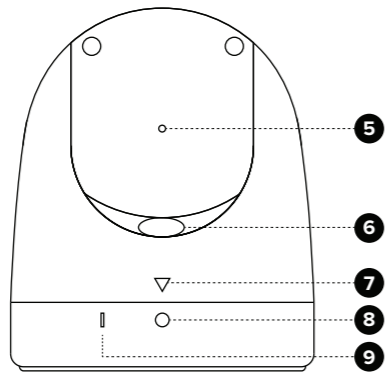

BACK

BASE PLATE

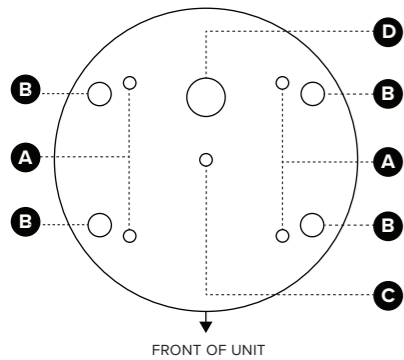

FRONT OF UNIT

**PARTS LEGEND**

1	PIVOTING HEAD
2	CAMERA OPTIC
3	MAIN HOUSING
4	BASE PLATE
5	STATUS LED
6	TILT LOCK
7	CENTER MARK
8	LOCKING SCREW
9	UNLOCK MARK
A	M6 THREADED
B	TOP DOWN THROUGH HOLES
C	1/4-20 TRIPOD MOUNT
D	CABLE HOLE

**LED STATUS**

ORANGE	BOOTING
BLUE	RUNNING
RED	FAULT

**INCLUDED**

- NIGHTWAVE CAMERA
- POWER + ANALOG VIDEO CABLE (5M)
- SMA TO BNC ADAPTER
- BNC TO RCA ADAPTER
- POWER FUSE + FUSE HOLDER
- DIGITAL USB VIDEO CABLE (2M)
- BASE GASKET
- MOUNTING HARDWARE KIT
- INSTALL TEMPLATE

**! Prior to installing the camera, consider the following:**

- Select an installation location as high as practical with minimum obstructions.
- Select an installation location that is greater than 1m from any magnetic compass.
- Select an installation location that is greater than 1m from any source of EMI.
- The mounting surface must be horizontal and level.
- Ensure the camera installation hardware does not weaken the boat's structure.
- Choose a drill size appropriate for the installation surface material and types of fasteners.
- Ensure there are no hidden structures, wires or conduits beneath the install area that may be damaged by the installation hardware.
- Ensure cable length and routing is adequate for installation location interference. (Radio, generators, motors, radar)

**THIS IS SIONYX.** We believe that human endeavor should not be limited by daylight. In the darkness of night, greatness is possible. Adventure enabled. And a full sense of all sight achievable, no matter the light.

**REGISTER YOUR DEVICE**

Register your device and stay up to date by visiting the URL or scanning the QR code below.



[www.sionyx.com/register](http://www.sionyx.com/register)

**NEED HELP?**

ONLINE CHAT	<a href="http://www.sionyx.com">www.sionyx.com</a>
SUBMIT A TICKET	<a href="http://www.sionyx.com/contact">www.sionyx.com/contact</a>
24/7 SUPPORT	<a href="http://www.support.sionyx.com">www.support.sionyx.com</a>

**FOLLOW US**

Share your SIONYX content and be sure to tag us!



**SIONYX NIGHTWAVE™ D1**

**QUICK START GUIDE**

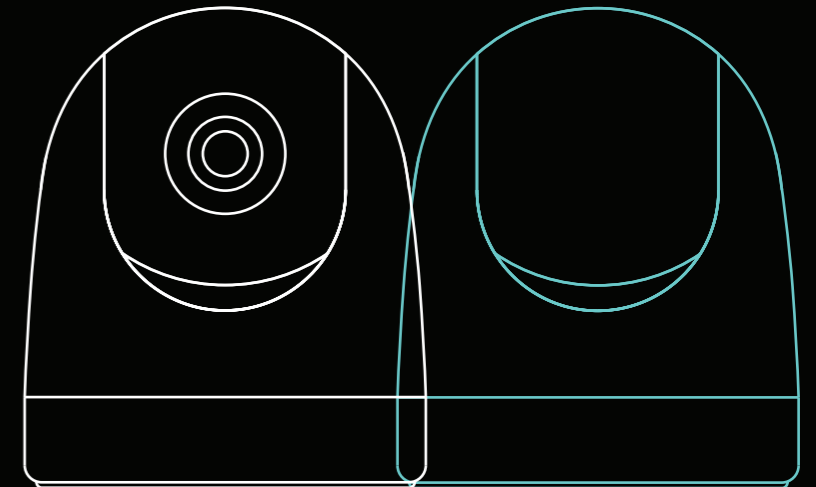

**SIONYX.COM**

## SEPARATE CAMERA FROM BASE PLATE

- 1 Loosen the **8** LOCKING SCREW.
- 2 Rotate **3** MAIN HOUSING until **9** UNLOCK MARK is aligned with the **7** CENTER MARK.
- 3 Separate the base plate from the camera. **FIG.1**

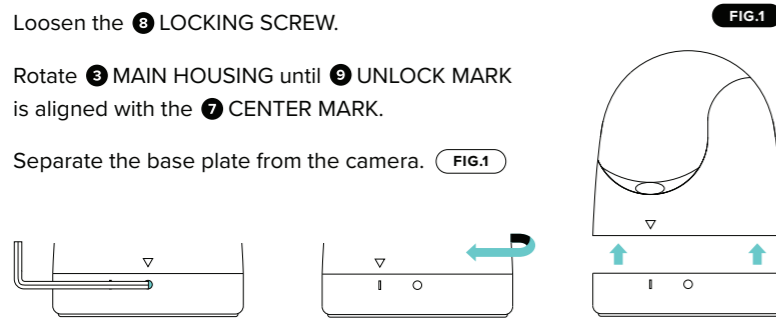

## CONNECT CABLES

- 1 Separate camera from base plate.
- 2 Remove cable retainer with the included Allen wrench. **FIG.2**
- 3 Remove rubber gasket from cable. **FIG.2B**
- 4 Remove connector protective cover. **FIG.2C**
- 5 Remove cable strain relief cover. **FIG.2D**
- 6 Separate connectors & remove cable from housing.
- 7 Feed new cable through housing **FIG.2A** & install rubber gasket around it. **FIG.2B**
- 8 Mate connectors, lay them in position and install the protective cover.
- 9 Pull extra cable slack through housing **FIG.2A** & re-install cable retainer. **FIG.2**
- 10 Re-connect the base plate to the camera.

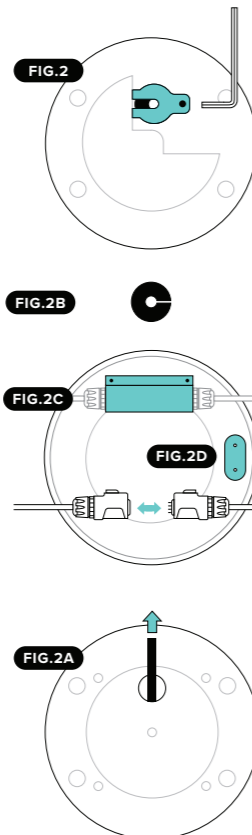

## CONNECT TO POWER

Follow marine electrical standards when wiring the camera.

- 1 Determine that proper voltage levels are available. (12V DC)
- 2 Finalize cable installation.
- 3 Install in-line fuse. **VII**
- 4 Connect power wires to corresponding positive and negative power terminals. **II + III**
- 5 If using USB-A connector instead, see **DIAGRAM 2**

## CONNECT TO VIDEO

- 1 Locate the video input on your display.
- 2 Install appropriate adapter if necessary. **FIG.4** **DIAGRAM 1**
- 3 Connect Analog video output **DIAGRAM 1** to Analog video input of your display.
- 4 If using USB-A connector instead, see **DIAGRAM 2**

## ADJUST THE TILT

- 1 Remove protective rubber cap and loosen the **6** TILT LOCK SET SCREW. **FIG.5**
- 2 Set the angle by manually adjusting the pivoting head of the camera, forward and back.
- 3 Gently tighten the set screw and replace the rubber protective cap.

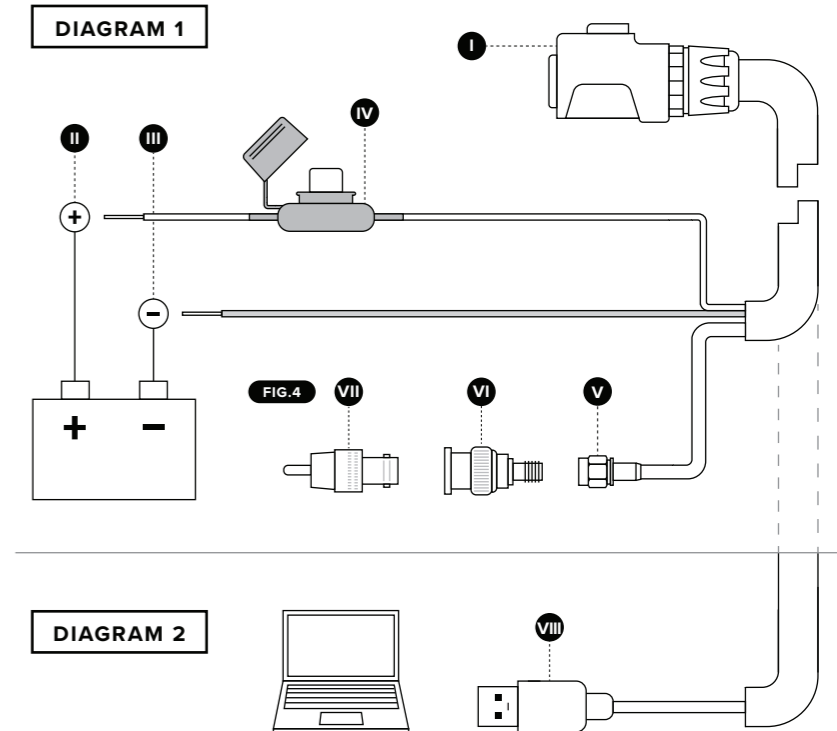
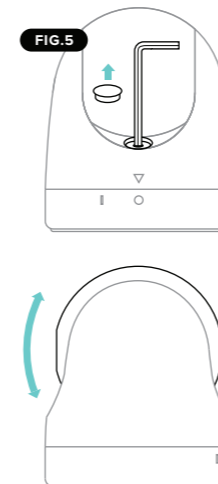

I	WATERPROOF CONNECTOR ON CAMERA END
II	+12V TERMINAL
III	GROUND TERMINAL
IV	IN-LINE FUSE HOLDER + FUSE
V	SMA VIDEO CONNECTION
VI	SMA TO BNC ADAPTER (USE IF NECESSARY)
VII	BNC TO RCA ADAPTER (USE IF NECESSARY)
VIII	USB POWER + VIDEO (SEPARATE CABLE)

**GET THE FULL USER MANUAL ►  
FOR INSTALL INSTRUCTIONS**

**Aim your cellphone camera at the QR code to download the full NIGHTWAVE User Manual.**



**EN** Full Documentation  
**FR** Documentation Complete  
**IT** Documentazione Completa  
**SP** Documentación Completa  
**DE** Vollständige Dokumentation